

GENERAL NOTES:

- ALL CONCRETE TO BE CLASS "P".
- SETTING TOLERANCE TO BE +0 & -1".
- WELDED WIRE MESH TO BE OVERLAPPED A MINIMUM 3" FOR SPLICE.
- OPENING TO MATCH TYPE OF PIPE SPECIFIED ON PLAN/PROFILE OR SUMMARY OF DRAINAGE STRUCTURES.
- THE MANUFACTURER SHALL BE RESPONSIBLE FOR THE PLACEMENT OF ALL PICK-UP AND HANDLING DEVICES.
- AFTER PLACEMENT OF PIPE, THE OPENING AROUND PIPE SHALL BE FILLED WITH FLEXIBLE PLASTIC JOINT MATERIAL.
- DIMENSIONS RELATING TO REINFORCED STEEL ARE TO BAR CENTERS.

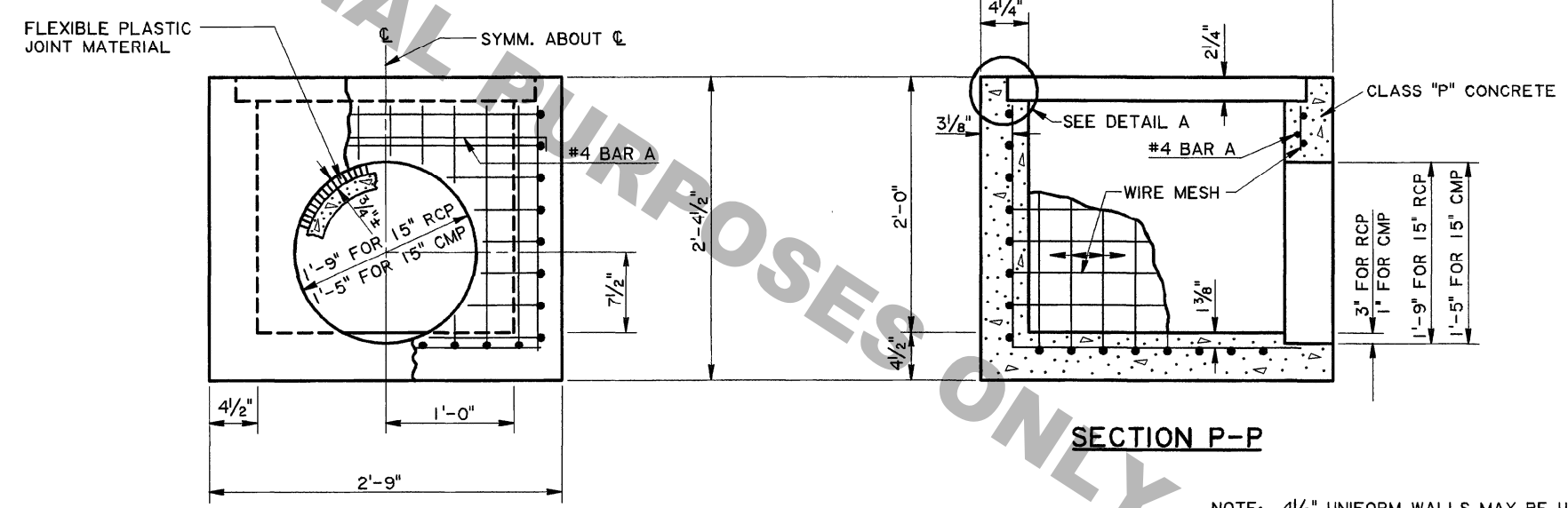

END ELEVATION

NOTE: 4 1/2" UNIFORM WALLS MAY BE USED AT SUPPLIER'S OPTION.

NOT TO BE USED WHERE SUBJECT TO VEHICULAR TRAFFIC.

NOTE: STANDARD PLAN MC-01 (DETAILS OF GRATES, FRAMES, SEATS, LIDS, ETC.) MAY BE OBTAINED FROM:
HYDRAULICS SECTION
DEPARTMENT OF TRANSPORTATION AND DEVELOPMENT
P.O. BOX 94245
CAPITOL STATION
BATON ROUGE, LA 70804

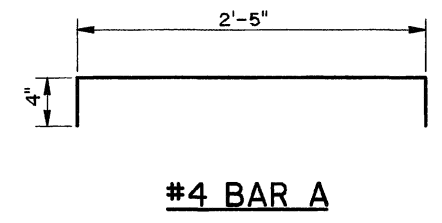

SHEET NUMBER		PARISH		FEDERAL PROJECT		STATE PROJECT	
DESIGNED	CDJ	CHECKED	WJR	DATE	1-30-80	SHEET	1 OF 1
Redrafted Original Standard				REVISION DESCRIPTION			
11-2-00				DATE			
APPROVED BY				BY			
CHIEF ENGINEER: R.E. D... ..				DATE: 11-2-00			
PRECAST OPEN TOP CATCH BASIN MAX. PIPE: 15" DEPTH: MINIMUM TO BE USED IN CONJUNCTION WITH STANDARD PLAN MC-01.							
STANDARD PLAN CB-04							
HYDRAULICS SECTION							